

Specifications of Inspiron 27 7720 All-in-One

Dimensions and weight

The following table lists the height, width, depth, and weight of your Inspiron 27 7720 All-in-One.

Table 2. Computer dimensions and weight (without stand)

Description		Values
Height		
	Front	394.82 mm (15.54 in.) i NOTE: The height of your computer varies depending on the stand installed.
	Rear	399.74 mm (15.73 in.) i NOTE: The height of your computer varies depending on the stand installed.
Width		614.70 mm (24.20 in.)
Depth		41.80 mm (1.64 in.)
Weight		<ul style="list-style-type: none"> • Non-touchscreen: 6.89 kg (15.19 lb) • Touchscreen: 7.18 kg (15.83 lb) i NOTE: The weight of your computer varies depending on the configuration ordered and the manufacturing variability.

Stand

The following table provides the height, width, depth, and weight of the stand supported by your Inspiron 27 7710 All-in-One.

Table 3. Stand

Description	Y stand	Isosceles stand
Height	96.81 mm (3.81 in.)	97.56 mm (3.84 in.)
Width	72.25 mm (2.84 in.)	66.95 mm (2.63 in.)
Depth	199.55 mm (7.85 in.)	200.46 mm (7.89 in.)
Weight	0.24 kg (0.53 lb)	0.32 kg (0.71 lb)

Y stand



The following table provides the dimensions of Y stand dimensions along with the computer.

Table 4. Y stand

Description	Dimensions
①	455.50 mm (17.93 in.)
②	199.55 mm (7.85 in.)
③	427.50 mm (16.83 in.)
④	244.84 mm (9.63 in.)
⑤	480.40 mm (18.91 in.)
⑥	611.11 mm (24.05 in.)

Isosceles stand

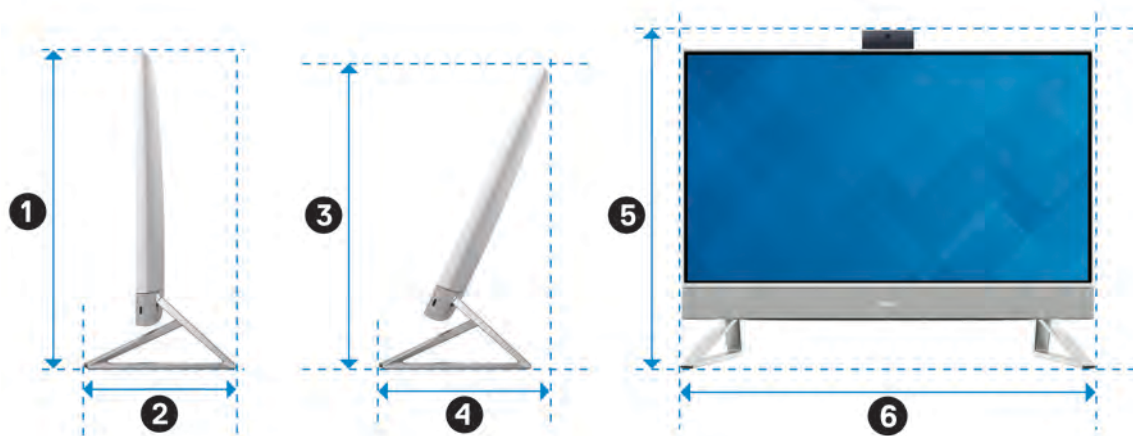

The following table provides the dimensions of Isosceles stand dimensions along with the computer.

Table 5. Isosceles stand

Description	Dimensions
①	455.50 mm (17.93 in.)
②	200.70 mm (7.90 in.)
③	427.50 mm (16.83 in.)
④	244.84 mm (9.63 in.)
⑤	480.40 mm (18.91 in.)
⑥	603.70 mm (23.76 in.)

Processor

The following table lists the details of the processors supported by your Inspiron 27 7720 All-in-One.

Table 6. Processor

Description	Option one	Option two
Processor type	13 th Generation Intel Core i7-1355U	13 th Generation Intel Core i5-1335U
Processor wattage	15 W	15 W
Processor total core count	10	10
Performance-cores	2	2
Efficient-cores	8	8
Processor total thread counts	12	12
 NOTE: Intel® Hyper-Threading Technology is only available on Performance-cores.		
Processor speed	Up to 5 GHz	Up to 4.60 GHz
Performance-cores frequency		
Processor base frequency	1.70 GHz	1.30 GHz
Maximum turbo frequency	5 GHz	4.60 GHz
Efficient-cores frequency		
Processor base frequency	1.20 GHz	0.90 GHz
Maximum turbo frequency	3.70 GHz	3.40 GHz
Processor cache	12 MB	12 MB
Integrated graphics	<ul style="list-style-type: none"> Intel UHD Graphics (For computers shipped with i5/i7 processors with Single Channel Memory Support) 	<ul style="list-style-type: none"> Intel UHD Graphics (For computers shipped with i5/i7 processors with Single Channel Memory Support)

Table 6. Processor (continued)

Description	Option one	Option two
	<ul style="list-style-type: none"> Intel Iris X^e Graphics (For computers shipped with i5/i7 processors with Dual Channel Memory Support) 	<ul style="list-style-type: none"> Intel Iris X^e Graphics (For computers shipped with i5/i7 processors with Dual Channel Memory Support)

Chipset

The following table lists the details of the chipset supported by your Inspiron 27 7720 All-in-One.

Table 7. Chipset

Description	Values
Chipset	Integrated in the processor
Processor	13 th Generation Intel Core i5/i7
DRAM bus width	128-bit
Flash EPROM	32 MB
PCIe bus	Up to Gen4

Operating system

Your Inspiron 27 7720 All-in-One supports the following operating systems:

- Windows 11 Pro
- Windows 11 Home

Memory

The following table lists the memory specifications of your Inspiron 27 7720 All-in-One.

Table 8. Memory specifications

Description	Values
Memory slots	Two SODIMM slots
Memory type	DDR4
Memory speed	3200 MHz
Maximum memory configuration	32 GB
Minimum memory configuration	8 GB
Memory size per slot	4 GB, 8 GB, 16 GB and 32 GB
Memory configurations supported	<ul style="list-style-type: none"> 8 GB, 1 x 8 GB, DDR4, 3200 MHz 12 GB, 1 x 4 GB + 1 x 8 GB, DDR4, 3200 MHz, dual-channel 16 GB, 1 x 16 GB, DDR4, 3200 MHz 16 GB, 2 x 8 GB, DDR4, 3200 MHz, dual-channel

Table 8. Memory specifications (continued)

Description	Values
	<ul style="list-style-type: none">• 32 GB, 1 x 32 GB, DDR4, 3200 MHz• 32 GB, 2 x 16 GB, DDR4, 3200 MHz, dual-channel

External ports

The following table lists the external ports of your Inspiron 27 7720 All-in-One.

Table 9. External ports

Description	Values
Network port	One RJ45 ethernet port
USB ports	<ul style="list-style-type: none">• Three USB 3.2 Gen 1 ports with Power on/Wake-up support• One USB 3.2 Gen 2 ports• One USB 3.2 Type-C Gen 2 port
Audio port	One Universal headset jack
Video port	<ul style="list-style-type: none">• One HDMI-out 1.4 / HDCP 2.3 port• One HDMI-in 1.4 / HDCP 1.4 port
Media-card reader	One SD-card 3.0 slot
Power-adaptor port	One 4.50 mm x 2.90 mm DC-in port
Security-cable slot	Not supported

Internal slots

The following table lists the internal slots of your Inspiron 27 7720 All-in-One.

Table 10. Internal slots

Description	Values
M.2	<ul style="list-style-type: none">• One M.2 2230/2280 slot for PCIe solid-state drive• One M.2 2230 slot for WiFi and Bluetooth combo card <p> NOTE: To learn more about the features of different types of M.2 cards, search in the Knowledge Base Resource at www.dell.com/support.</p>
SATA	One SATA slot for 2.5-inch HDD

Ethernet

The following table lists the wired Ethernet Local Area Network (LAN) specifications of your Inspiron 27 7720 All-in-One.



Table 11. Ethernet specifications

Description	Values
Model number	Intel AX211 PCI-e Gigabit ethernet controller/Killer 1690i PCI-e Gigabit ethernet controller
Transfer rate	10/100/1000 Mbps

Wireless module

The following table lists the Wireless Local Area Network (WLAN) modules supported on your Inspiron 27 7720 All-in-One.

Table 12. Wireless module specifications

Description	Option one	Option two
Model number	Intel AX201	Intel AX211
Transfer rate	Up to 2400 Mbps	Up to 2400 Mbps
Frequency bands supported	2.40 GHz/5 GHz	2.40 GHz/5 GHz/6 GHz
Wireless standards	<ul style="list-style-type: none"> • WiFi 802.11a/b/g • Wi-Fi 4 (WiFi 802.11n) • Wi-Fi 5 (WiFi 802.11ac) • Wi-Fi 6 (WiFi 802.11ax) 	<ul style="list-style-type: none"> • WiFi 802.11a/b/g • Wi-Fi 4 (WiFi 802.11n) • Wi-Fi 5 (WiFi 802.11ac) • Wi-Fi 6/6E (WiFi 802.11ax)
Encryption	<ul style="list-style-type: none"> • 64-bit/128-bit WEP • AES-CCMP • TKIP 	<ul style="list-style-type: none"> • 64-bit/128-bit WEP • AES-CCMP • TKIP
Bluetooth wireless card	Bluetooth 5.2 wireless card  NOTE: Particular versions of Microsoft Windows may not support the full Bluetooth wireless card functionality.	Bluetooth 5.3 wireless card  NOTE: Particular versions of Microsoft Windows may not support the full Bluetooth wireless card functionality.

Audio

The following table lists the audio specifications of your Inspiron 27 7720 All-in-One.

Table 13. Audio specifications

Description	Values
Audio controller	Waves MaxxAudio Pro
Stereo conversion	Supported
Internal audio interface	High definition audio interface
External audio interface	One Universal headset Jack

Table 13. Audio specifications (continued)

Description		Values
Number of speakers		2
Internal-speaker amplifier		Supported
External volume controls		Not supported
Speaker output:		
	Average speaker output	5 W x 2 = 10
	Peak speaker output	6 W x 2 = 12
Subwoofer output		Not supported
Microphone		Digital-array microphones in camera assembly

Storage

This section lists the storage options on your Inspiron 27 7720 All-in-One.

Table 14. Storage matrix

Storage Options		M.2 solid-state drive	2.5-inch hard drive	Bootable Device
M.2 solid-state drive		Y	N	Y
M.2 solid-state drive	2.5-inch hard drive	Y	Y	Y

Table 15. Storage specifications

Storage type	Interface type	Capacity
2.5-inch hard-drive, 5400 RPM	SATA AHCI, up to 6 Gbps	Up to 1 TB
2.5-inch hard-drive, 7200 RPM	SATA AHCI, up to 6 Gbps	Up to 1 TB
M.2 2230, solid-state drive	PCIe NVMe Gen3 x4, up to 32 Gbps	Up to 1 TB
M.2 2230, solid-state drive	PCIe NVMe Gen4 x4, up to 64 Gbps	Up to 1 TB

Media-card reader

The following table lists the media cards supported by your Inspiron 27 7720 All-in-One.

Table 16. Media-card reader specifications

Description	Values
Media-card type	One SD-card 3.0 slot
Media-cards supported	<ul style="list-style-type: none"> Secure Digital (SD) Secure Digital High Capacity (SDHC) Secure Digital Extended Capacity (SDXC)
 NOTE:	The maximum capacity supported by the media-card reader varies depending on the standard of the media card installed in your computer.

Camera

The following table lists the camera specifications of your Inspiron 27 7720 All-in-One.

Table 17. Camera specifications

Description		Option one	Option two
Number of cameras		One	One
Camera type		FHD RGB camera	FHD RGB + Infrared camera
Camera location		Front camera	Front camera
Camera sensor type		CMOS sensor technology	CMOS sensor technology
Camera resolution:			
	Still image	2.07 megapixel	2.07 megapixel
	Video	1920 x 1080 (FHD) at 30 fps	1920 x 1080 (FHD) at 30 fps
Infrared camera resolution:			
	Still image	Not supported	0.31 megapixel
	Video	Not supported	640 x 480 (VGA) at 40 fps
Diagonal viewing angle:			
	Camera	82 degrees	82 degrees
	Infrared camera	Not supported	77.30 degrees

Power adapter

The following table lists the power adapter specifications of your Inspiron 27 7720 All-in-One.

Table 18. Power adapter specifications

Description		Option one	Option two
Type		90 W AC	130 W AC
Connector dimensions:			
	External diameter	4.50 mm (0.17 in.)	4.50 mm (0.17 in.)
	Internal diameter	2.90 mm (0.11 in.)	2.90 mm (0.11 in.)
Power-adapter dimensions:			
	Height	1.30 mm (0.05 in.)	1.00 mm (0.04 in.)
	Width	2 mm (0.08 in.)	3 mm (0.12 in.)
	Depth	5 mm (0.20 in.)	6.1 mm (0.24 in.)
Input voltage		100 VAC–240 VAC	100 VAC–240 VAC
Input frequency		50 Hz–60 Hz	50 Hz–60 Hz

Table 18. Power adapter specifications (continued)

Description		Option one	Option two
Input current (maximum)		1.50 A	1.80 A
Output current (continuous)		4.62 A (continuous)	6.67 A (continuous)
Rated output voltage		19.5 VDC	19.5 VDC
Temperature range:			
	Operating	0°C to 40°C (32°F to 104°F)	0°C to 40°C (32°F to 104°F)
	Storage	-40°C to 70°C (-40°F to 158°F)	-40°C to 70°C (-40°F to 158°F)
 CAUTION: Operating and storage temperature ranges may differ among components, so operating or storing the device outside these ranges may impact the performance of specific components.			

Display

The following table lists the display specifications of your Inspiron 27 7720 All-in-One.

Table 19. Display specifications

Description		Option one	Option two
Display type		27-inch, Full High Definition (FHD)	27-inch, Full High definition (FHD)
Touch options		Touch support with 10 touch points	Not supported
Display-panel technology		Wide View Angle (WVA)	Wide view Angle (WVA)
Display-panel dimensions (active area):			
	Height	336.31 mm (13.24 in.)	336.31 mm (13.24 in.)
	Width	597.88 mm (23.54 in.)	597.88 mm (23.54 in.)
	Diagonal	685.98 mm (27.01 in.)	685.98 mm (27.01 in.)
Display-panel native resolution		1920 x 1080	1920 x 1080
Luminance (typical)		250 nits	300 nits
Megapixels		2.07 M	2.07 M
Color gamut		99% (sRGB) - typical	99% (sRGB) - typical
Pixels Per Inch (PPI)		81	81
Contrast ratio (min.)		700:1	700:1
Response time (max.)		28 ms	25 ms
Refresh rate		60 Hz	60 Hz
Horizontal view angle		+/- 80 degrees (min.)	+/- 80 degrees (min.)
Vertical view angle		+/- 80 degrees (min.)	+/- 80 degrees (min.)

Table 19. Display specifications (continued)

Description	Option one	Option two
Pixel pitch	0.3114 mm x 0.3114 mm	0.3114 mm x 0.3114 mm
Power consumption (maximum)	19.64 W	19.24 W
Anti-glare vs glossy finish	TrueLife	Anti-glare

GPU—Integrated

The following table lists the specifications of the integrated Graphics Processing Unit (GPU) supported by your Inspiron 27 7720 All-in-One.

Table 20. GPU—Integrated

Controller	Memory size	Processor
Intel UHD Graphics (For computers shipped with i5/i7 processors with Single Channel Memory Support)	Shares system memory	<ul style="list-style-type: none"> 13th Generation Intel Core i5/i7
Intel Iris X ^e Graphics (For computers shipped with i5/i7 processors with Dual Channel Memory Support)	Shares system memory	<ul style="list-style-type: none"> 13th Generation Intel Core i5/i7

GPU—Discrete

The following table lists the specifications of the discrete Graphics Processing Unit (GPU) supported by your Inspiron 27 7720 All-in-One.

Table 21. GPU—Discrete

Controller	Memory size	Memory type
NVIDIA GeForce MX550	2 GB	GDDR6

Environmental

The following table lists the environmental specifications of your Inspiron 27 7720 All-in-One.

Table 22. Environmental

Feature	Values
Recyclable packaging	Yes
BFR/PVC—free chassis	No
Vertical orientation packaging support	Yes
Multi-Pack packaging	No
Energy-Efficient Power Supply	Standard
ENV0424 compliant	Yes

NOTE: Wood-based fiber packaging contains a minimum of 35% recycled content by total weight of wood-based fiber. Packaging that contains without wood-based fiber can be claimed as Not Applicable. The anticipated required criteria for EPEAT 2018.

Regulatory compliance

The following table lists the regulatory compliance of your Inspiron 27 7720 All-in-One.

Table 23. Regulatory compliance

Regulatory compliance
EPEAT registered configurations available
ENERGY STAR compliant configurations available
TCO 8.0 certified configurations available
US CEC MEPS compliant configurations available
Australia and New Zealand MEPS compliant configurations available
CEL
WEEE
Japan Energy Law
South Korea E-standby
EU RoHS
China RoHS

Operating and storage environment

This table lists the operating and storage specifications of your Inspiron 27 7720 All-in-One.

Airborne contaminant level: G1 as defined by ISA-S71.04-1985

Table 24. Computer environment

Description	Operating	Storage
Temperature range	0°C to 35°C (32°F to 95°F)	-40°C to 65°C (-40°F to 149°F)
Relative humidity (maximum)	10% to 90% (non-condensing)	0% to 95% (non-condensing)
Vibration (maximum)*	0.66 GRMS	1.30 GRMS
Shock (maximum)	110 G†	160 G†
Altitude range	0 m to 3048 m (0 ft to 10000 ft)	0 m to 10668 m (0 ft to 35000 ft)
 CAUTION: Operating and storage temperature ranges may differ among components, so operating or storing the device outside these ranges may impact the performance of specific components.		

* Measured using a random vibration spectrum that simulates user environment.

† Measured using a 2 ms half-sine pulse.

Dell Support policy

For information on Dell support policy, search in the Knowledge Base Resource at www.dell.com/support.